

# Pumped Hydro Storage Workshop

October 17, 2008  
Scott Tillman

# NSC Smelter, LLC

- NSC Smelter owns an idle aluminum smelter in Goldendale, WA (located 120 miles east of Portland, OR)
- Plant is situated alongside the John Jay Dam on the Columbia River
- Following a change in ownership, a thorough review of assets was undertaken

# Overview of Property

- We own 7,000 acres of property adjacent to the Columbia River
  - Approximately 1,000 acres is a low land bench situated alongside the Columbia River at an elevation of approximately 600 ft msl.
  - Approximately 6,000 acres at the top of downward sloping escarpment at an elevation of 2,500 ft msl.
  - Wind farm will operate 29 turbines by year end on our property, part of a much larger development.

Google Maps goldendale, wa Search Maps Show search options  
Find businesses, addresses and places of interest. Learn more

Get Directions My Maps Print Send Link

Results 1 - 1 of about 1 for Goldendale, WA

Goldendale, WA

Explore this area »

Photos



Popular Searches

goldendale washington motel  
maryhill museum mini storage

More photos, videos, and user-created maps »

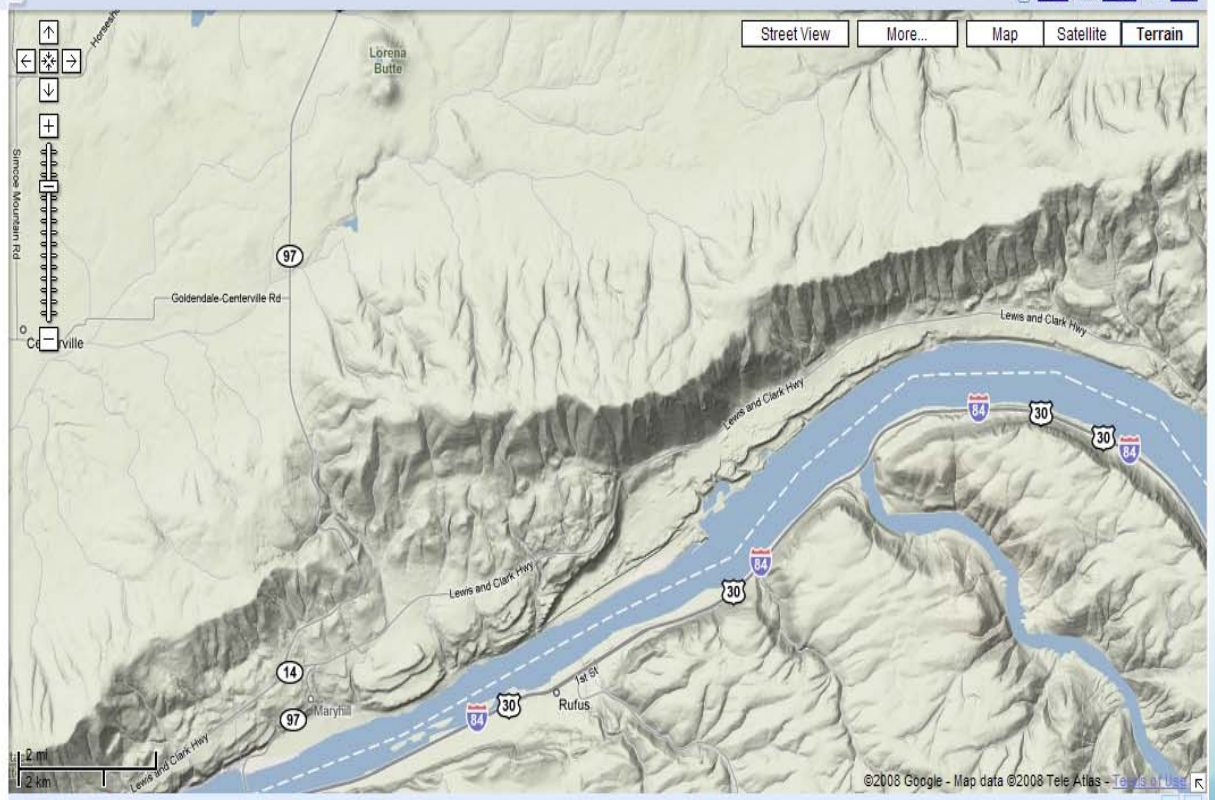

Goldendale WA Hotels - washington-hotel.org - The Washington Hotel Site. Discount Goldendale WA Hotels. Sponsored Link

# Unique Attributes to our Site

- Location
  - Proximity to Pacific Interconnect
  - Large and growing wind presence
- Topography (Gross head of approximately 1,700 ft)
- Original plant required substantial production plant substation and transmission lines
- We have significant Water Rights



# The beginnings of many wind projects



\* Pictures look to the Northeast

# Proximity to Energy Infrastructure



\* Looking down at the John Jay Dam and our plant

# Transmission Lines Surround Us







# Potential Upper & Lower Reservoir Sites

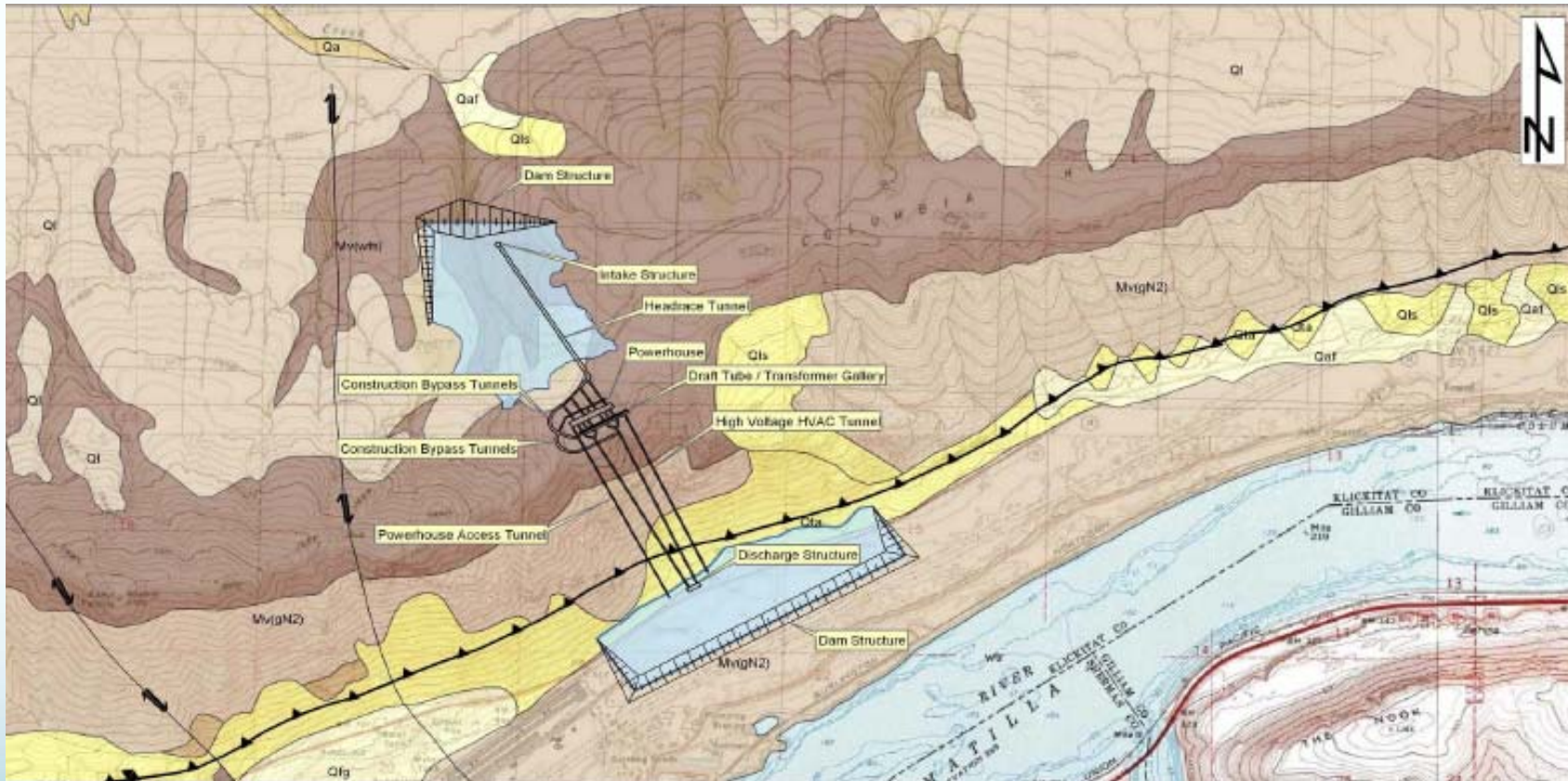

Initial estimates are for a 1050MW plant



# Potential Upper Reservoir





\* View of plant, and site for lower reservoir looking east

# Q & A

- Thank you!